

DECKED

INSTALLATION INSTRUCTIONS*



CARGOGLIDE 600/1000/1500 TRUCK BED INSTALL

***DO NOT USE THESE INSTRUCTIONS FOR
INSTALLATION ONTO A DECKED DRAWER SYSTEM***

*Trust us on this one; don't go commando and attempt your install without reading.
You'll just cuss a bunch and create even more chaos in your truck.

URC620

TOOLS REQUIRED

- Drill
- 5/16" and 1/2" drill bits
- 5/16" and 1/2" drill stops
- Tape measure
- Crescent wrench
- Knife
- 1/2" socket
- Ratchet or impact driver

TOOLS NEEDED FOR ROLLER HEIGHT ADJUSTMENT (Troubleshooting section)

- 9/16" socket
- 1/4" hex wrench
- 3/16" hex wrench

INSTALL VIDEO

High tech link to video here or you can visit decked.com/installvideo



CONTENTS

- Plus nut tool (assembled on 2.5" bolt with washer and plus nut)
- Mounting hardware: plus nuts, 1.5" bolts, washers
- Tiedowns (4) and hardware
- Primer

HEY! TORQUE BOY

READ BEFORE YOU INSTALL

Welcome to DECKED! In a world of crappy instructions, bad advice, and questionable sources of truth, we are here to make sure that your install goes as smoothly as possible, saving you headaches and heartburn. That said, your part is to read the darned instructions!

Warning: It is the responsibility of the installer to ensure the DECKED 600/1000 unit is securely fastened to a base which will provide safe and reliable operation.

DO NOT INSTALL IN TRUCKS WITH:

- PLASTIC BEDLINERS
- RUBBER MATS
- GMC COMPOSITE BEDS
- TUNDRA COMPOSITE BEDS (2022+ model years)
- TACOMAS ARE OK - FOLLOW THE DIRECTIONS AS WRITTEN.

The many variations in application and placement of a sliding platform present specific issues to consider for safety and utility.

The following recommendations are intended to be general in nature and provide important safety information for the installer to consider during installation.

**DO NOT DRILL INTO ELECTRIC
OR HYBRID VEHICLES UNTIL
BATTERY LOCATION HAS BEEN
CONFIRMED.**

USAGE

All DECKED CargoGlide units are designed for use in stationary and level conditions only. When installed in a vehicle, the DECKED CargoGlide unit must be closed and latched securely prior to and during any vehicle movement. The vehicle must be parked in a level position prior to unlocking and extending a DECKED CargoGlide unit; Otherwise, the weight of your cargo could be difficult or dangerous to move. Control loads by opening and closing slowly. Heavy, uncontrolled loads may cause bodily injury or damage your DECKED CargoGlide latch or safety stop systems. Regular inspection is recommended.

Use two hands to operate the CargoGlide tray.

FORCES

The DECKED CargoGlide unit must be securely fastened to a base floor or other structure to prevent movement. A tipping force is applied to the unit when it is extended, which is countered by the attachments at the front (cabside) and middle of the unit. Furthermore, vehicle acceleration, cornering and braking will result in additional forces affecting your cargo and the DECKED CargoGlide unit. Impacts due to dropping a load will result in temporary higher forces impacting the fasteners and should be avoided.

CLEARANCE

Many vehicle compartments have a lip on the bottom of the bed, or angled tailgates and other obstructions above the floor level.

To assure the tailgate never interferes with the DECKED CargoGlide system, there should be at minimum of 1" of vertical clearance, with no load, between the tailgate and the lowest extended point of the DECKED CargoGlide.

The tray can be raised with an easy adjustment if additional clearance is required. See TROUBLESHOOTING at the end of the manual. This adjustment is not available or necessary on 80-95" units.

There may be installation situations where an obstruction below the vehicle bed surface prevents using a plus nut, requiring the use of long bolts and/or other fasteners that are not included.

WARNING: PRIOR TO DRILLING HOLES FOR PLUSNUT INSTALLATIONS, CONFIRM THAT THERE ARE NO FUEL LINES, FUEL TANKS, BATTERIES, WIRES OR OTHER OBSTRUCTIONS UNDER THE VEHICLE THAT MAY BE DAMAGED WHERE YOU WILL BE DRILLING HOLES.

If you have purchased high sides for your CargoGlide, it is recommended that these be installed before the unit is installed in the truck bed to confirm proper clearance on all sides.

DECKED DRAWER SYSTEM COMPATIBILITY:

DECKED LEGACY SYSTEMS (have ammo cans) - not compatible
NEW DECKED DRAWER SYSTEM (no ammo cans) installs require the purchase of no-drill brackets and instructions from DECKED.com. DO NOT DRILL INTO YOUR DRAWER SYSTEM!

STEP 1: GET CENTERED

1. It is recommended to cut the flaps of the box top off and lay it in the vehicle bed to prevent scratches to the bed when positioning the DECKED CargoGlide unit. Be sure to remove the box after positioning the unit.
2. NOTE: INSTALL HIGH SIDES NOW. If you purchased high sides, install them prior to installing the CargoGlide to the truck bed. This will ensure proper clearance. There may be less clearance higher up the truck bed wall. See DETAIL A. Refer to high side instructions for install.
3. Find a friend and place the entire DECKED CargoGlide unit into the bed of the truck. Push to the cabside and center the unit between the wheel wells. CG600's can be offset as desired, depending on your preference.
4. Close the tailgate to ensure proper clearance.
5. Check to ensure nothing interferes with the location and operation of the DECKED CargoGlide, including clearance of the tailgate, optional high sides and/or doorway edges.
6. Loads placed on the DECKED CargoGlide may cause deflection, reducing the tailgate clearance. It is necessary to ensure at least 1" to 2" between the lowest part of the CargoGlide and the highest point on the tailgate. All CG600/1000 units up to 79" in length offer a height adjustment to raise the tray.

See TROUBLESHOOTING at the end of the manual.

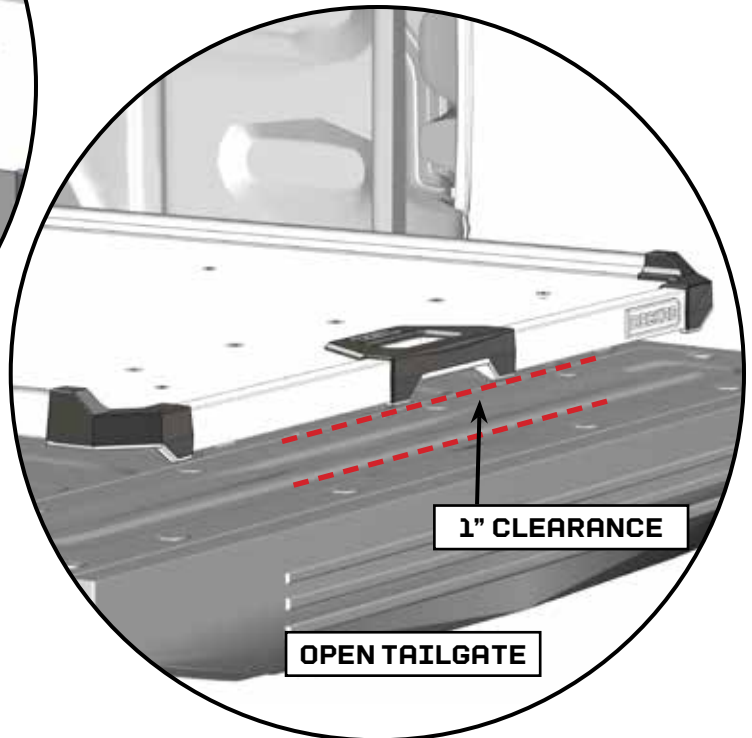
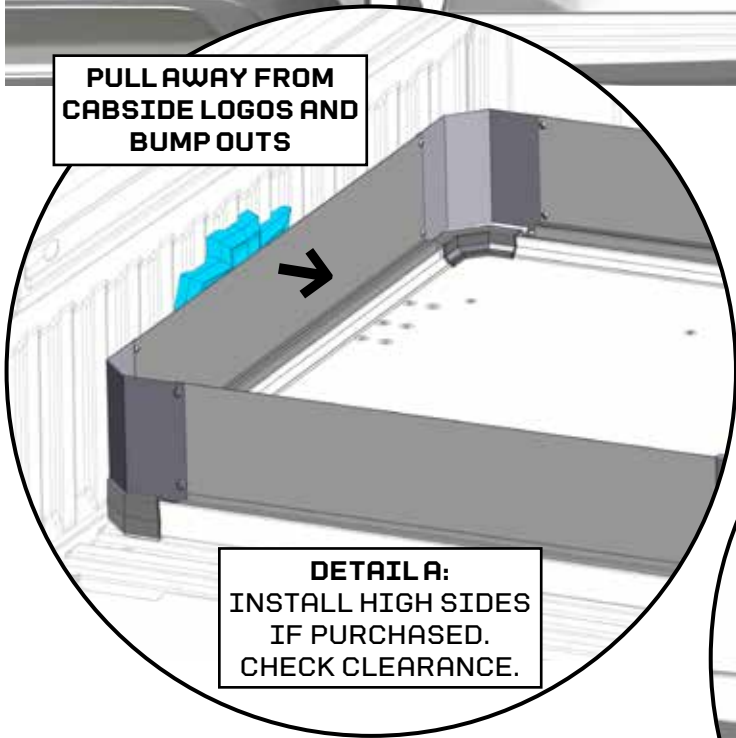
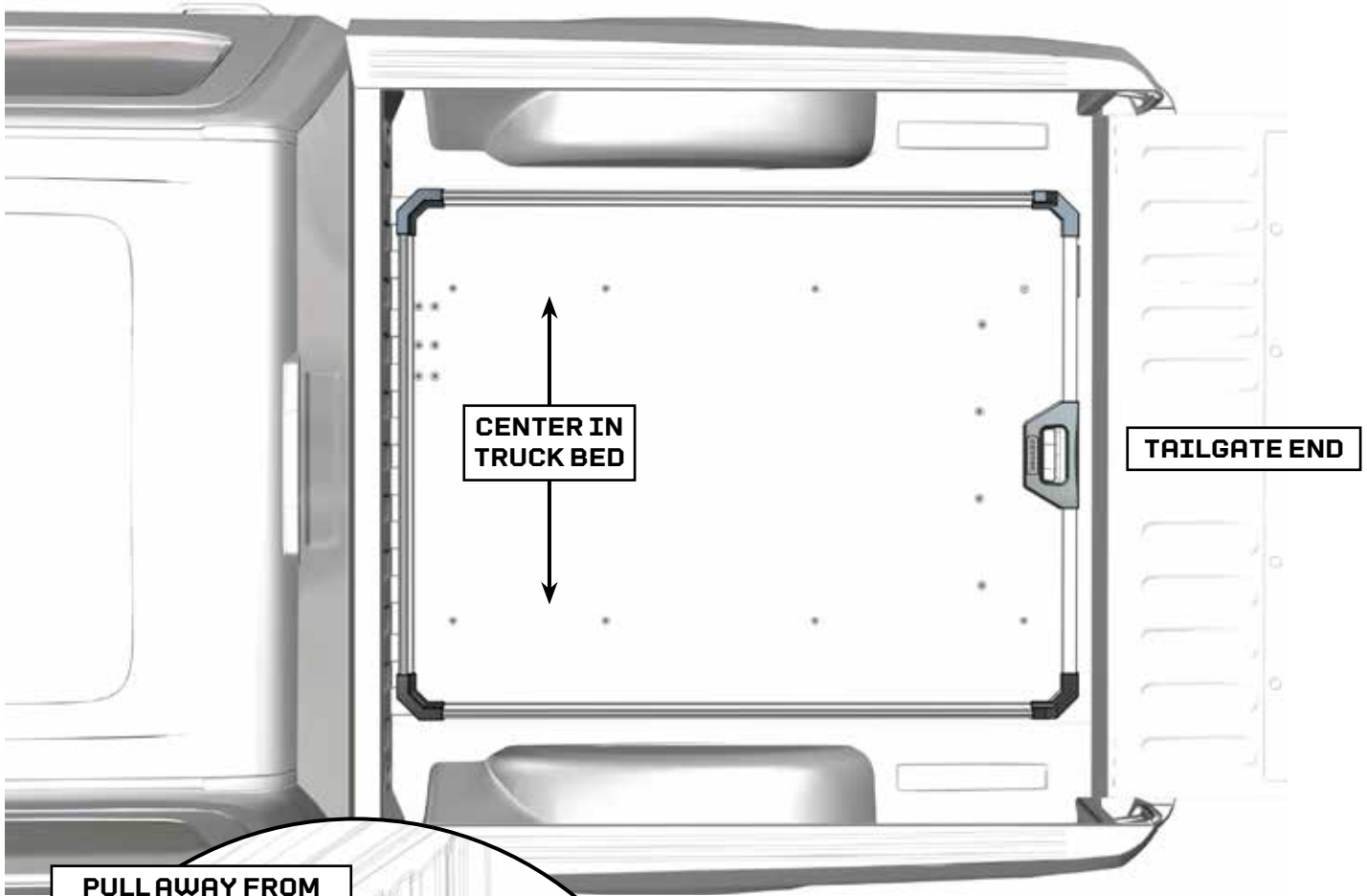

STEP 2: POSITION AND CHECK CLEARANCE

1. Open the tailgate, disengage the tray latch and pull the tray until all crossmembers are exposed.
2. Support the open tray with your favorite sawhorse or friend.
3. Measure from the cabside bulkhead to the bottom mounting frame. There should be a minimum of 1/2" clearance. **DETAIL A.**
4. Measure side to side from the CargoGlide to the bed wall at both the front and back of the unit to confirm it is properly centered. **DETAIL B.**
5. Verify fitment in truck bed with tailgate closed before drilling.

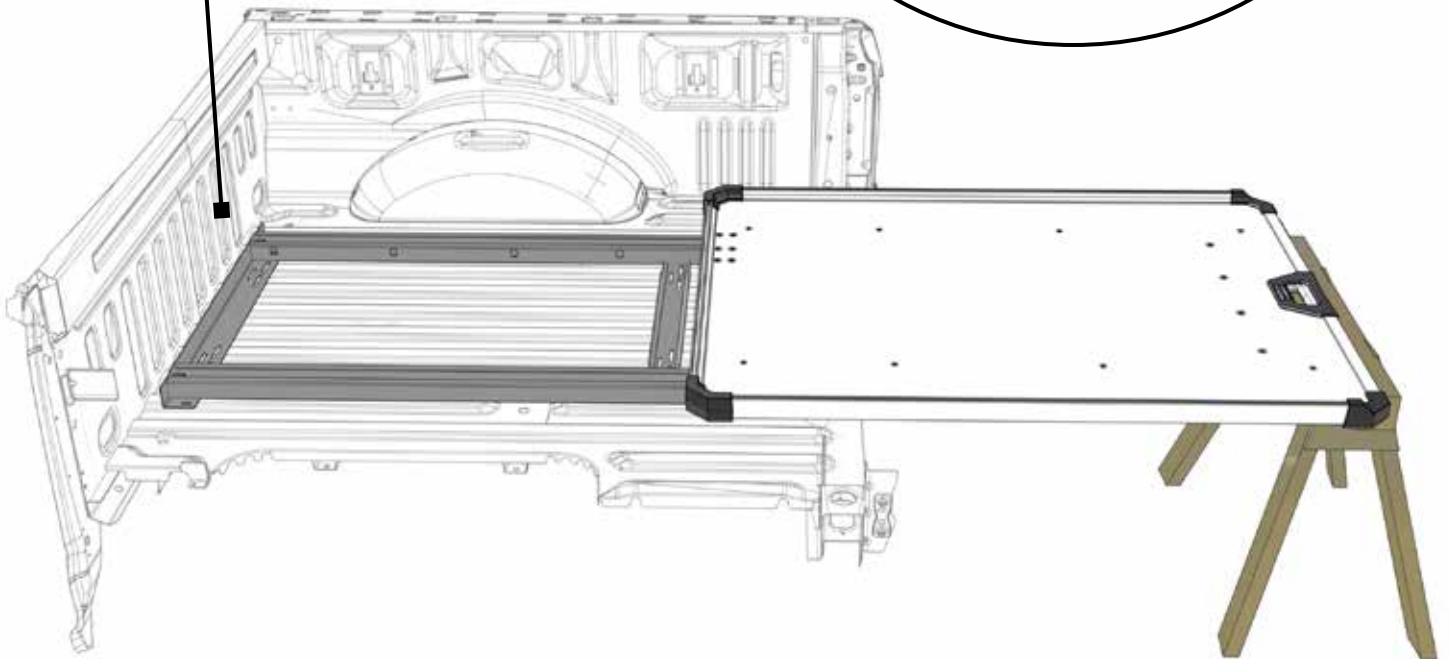
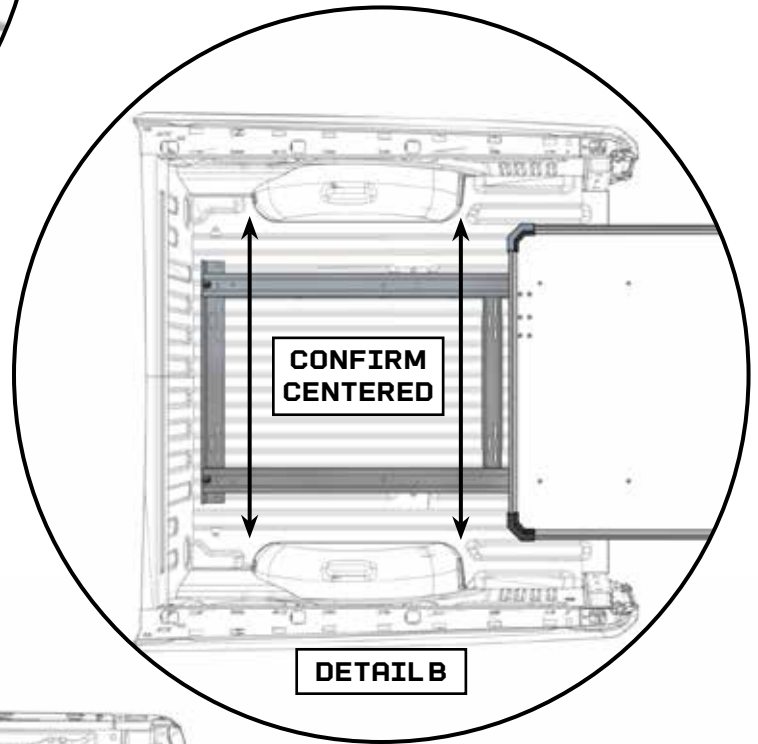
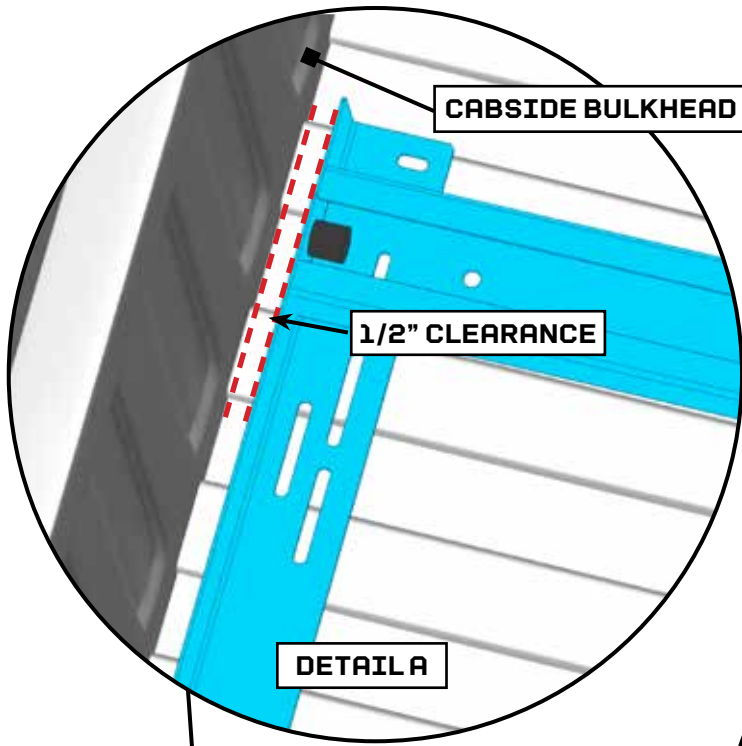

STEP 3:

ALIGN FRAME AND MARK MOUNTING HOLES

NOTE:

52-75" LONG UNITS

The bottom frame has TWO (2) crossmembers.
You will need to install FOUR (4) plusnuts for four mounting points.

80-95" LONG UNITS

The bottom frame has THREE (3) crossmembers.
You will need to install SIX (6) plusnuts for six mounting points.

1. Slots are placed at each mounting point in the bottom frame (blue circles in graphics on right).
2. Ask a friend or a sawhorse to support the tailgate end of the CG opened to expose all crossmembers and correctly positioned in the bed.
3. Locate a fastening position through the cabside bottom frame mounting positions nearest the center on the top of a floor rib. Mark with a marking pen.

NOTE: Holes must be placed at least 1/4" from any edges of the top flat rib surface.

4. For most vehicles, these slots ensure plusnuts can be installed on the top and in the middle of the floor ribs.

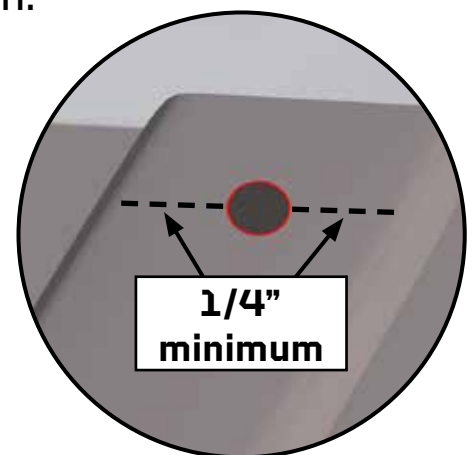

CG2.0 with 2
crossmembers (52-73") =
4 mounting points

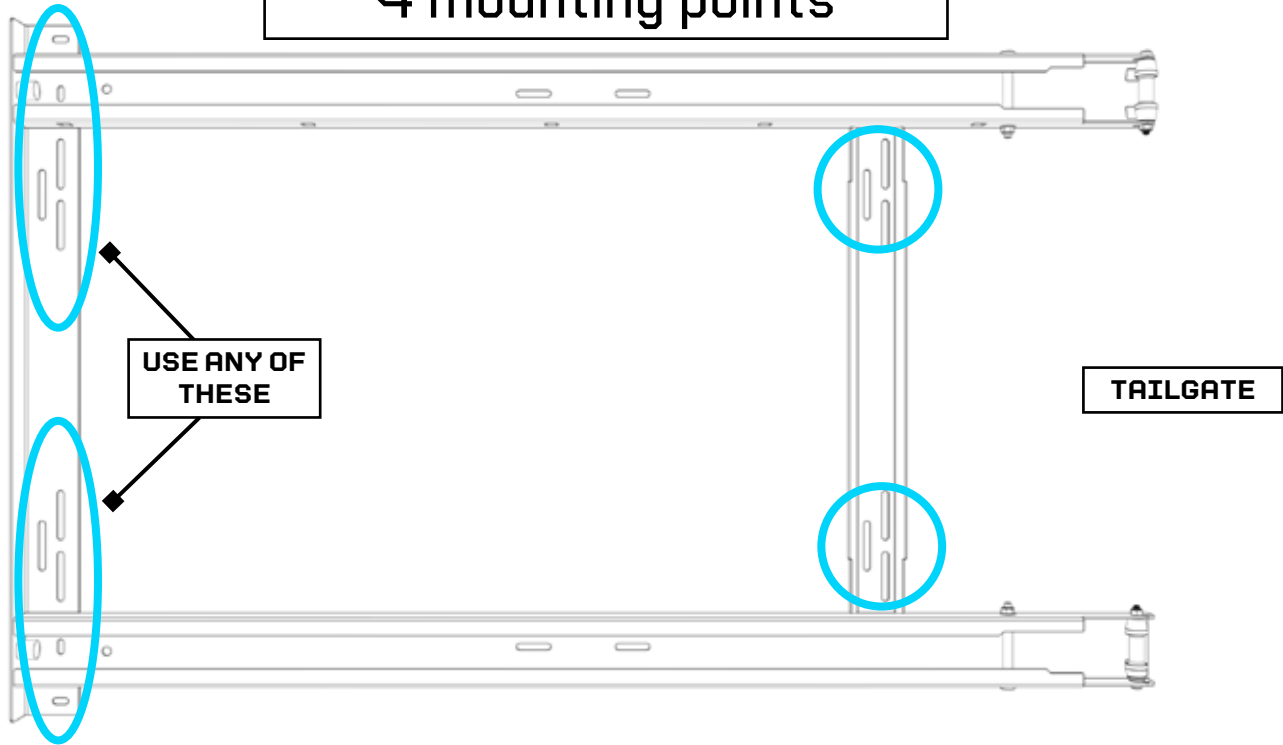

CG2.0 with 3
crossmembers (80"+) =
6 mounting points

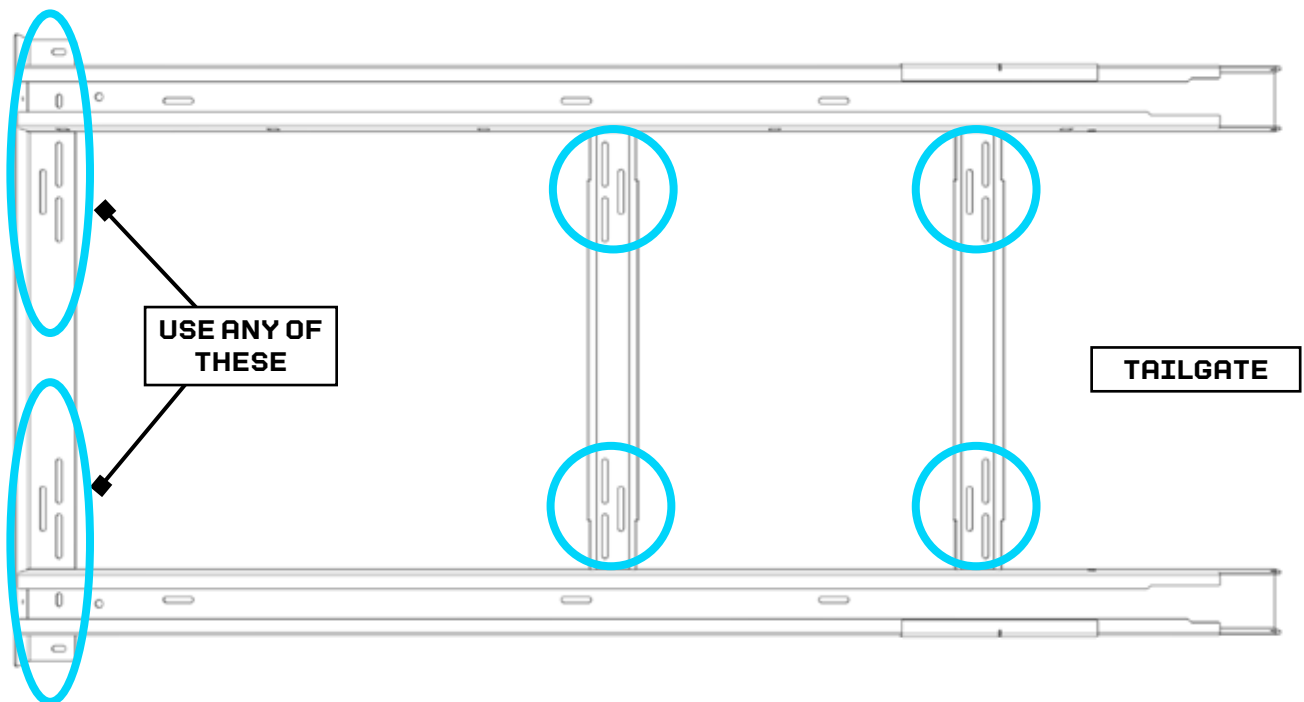

STEP 4:

DRILL MOUNTING HOLES

IMPORTANT:

ELECTRIC AND HYBRID VEHICLES MAY HAVE BATTERIES AND/OR HIGH VOLTAGE ELECTRICAL LINES UNDER THE TRUCK BED.

CONFIRM LOCATIONS OF ALL BATTERIES AND ELECTRICAL LINES BEFORE DRILLING INTO YOUR BED. DO NOT DRILL INTO BATTERIES OR ELECTRICAL LINES.

1. Install a drill stop onto a 5/16" bit. Set to 1/2" depth.
2. Use the frame as a guide to drill pilot holes in the four or six mounting locations with the 5/16" bit.
3. Install a drill stop onto a 1/2" bit. Set to 1/2" depth.
4. Move the CargoGlide frame a few inches out of your way and use the 1/2" bit to enlarge the holes you just made.
5. Seal the raw edges with the self-etching PRIMER included in your hardware kit. Let it dry.
6. Insert a plusnut anchor into each hole.
7. Using a wrench to hold the plus nut compression tool in place, use a ratchet and socket or impact driver to tighten the bolt into the plus nut. As you tighten the bolt, you will feel strong resistance, then light resistance, then strong resistance again as it crimps the plus nut anchor under the vehicle bed.
DO NOT OVERTIGHTEN.
8. After the plus nut has been fully crimped, remove the bolt and repeat on the other mounting locations.

STEP 1

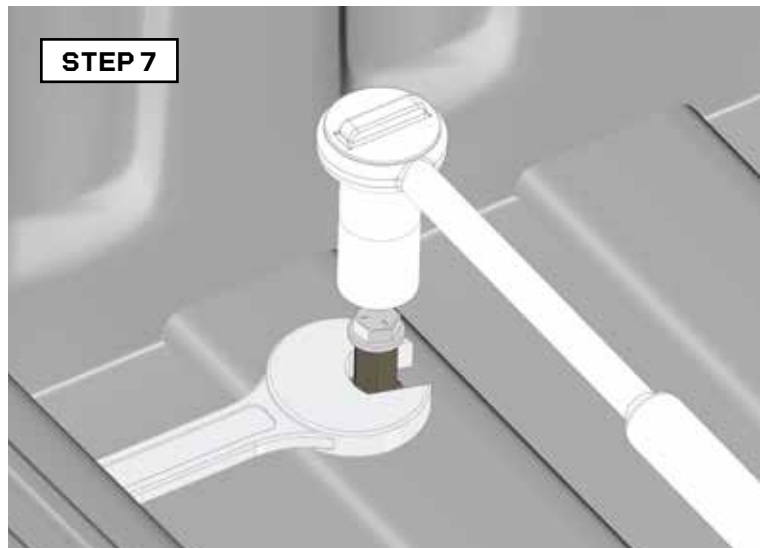
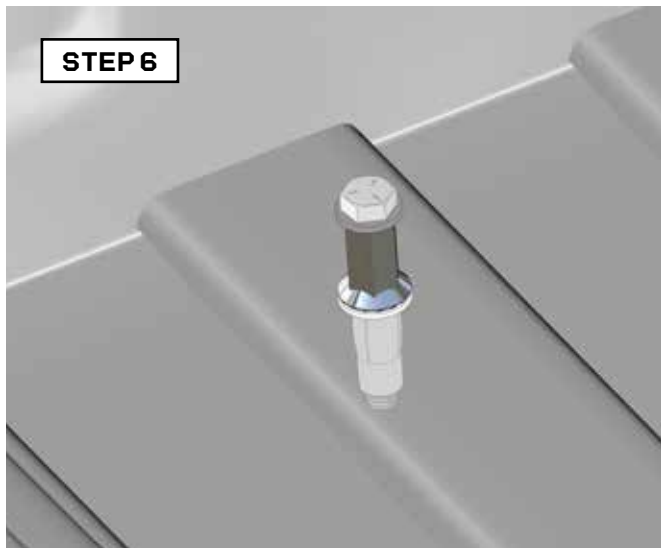
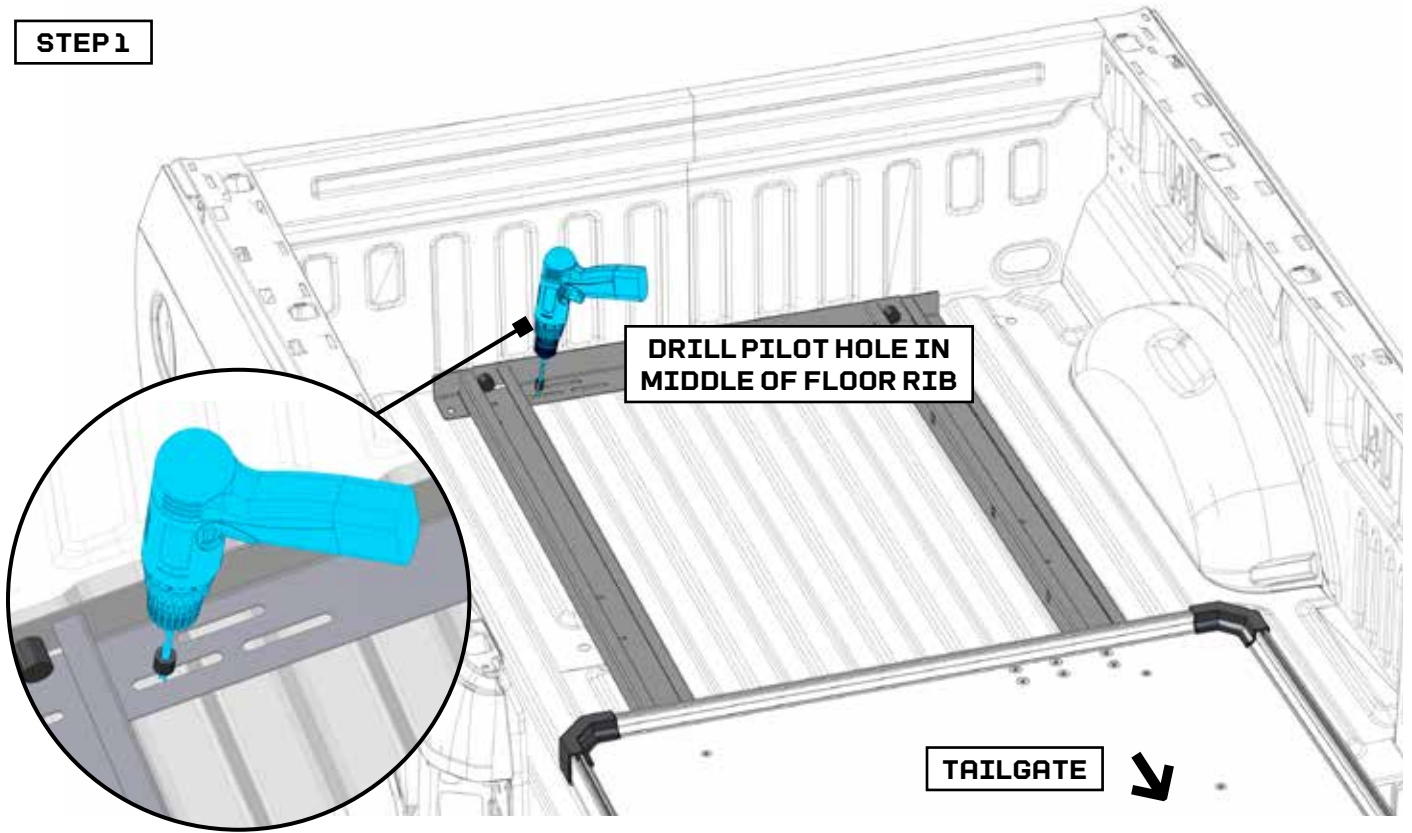

STEP 5: FASTEN AND TEST UNIT

1. Move the frame back into place over the plus nuts.
2. Install the 5/16" bolts from your installation kit. Install a washer on the bolt and install through the mounting hole in the DECKED Cargo Glide frame and into the plus nut. Hand tighten each bolt.

After all bolts are in place, tighten each securely in each of the mounting positions.

3. Inspect periodically to ensure bolts remain securely fastened.
4. **SAFETY CHECK:** Prior to placing any cargo on the unit, test function: Carefully slide out unit, releasing latch handle to ensure it stops at each stop position and that there is safe clearance for fingers, tailgates, etc.

NOTE: If tailgate rollers feel tight or constricted, they are easily adjustable. See **TROUBLESHOOTING** section for adjustment instructions.

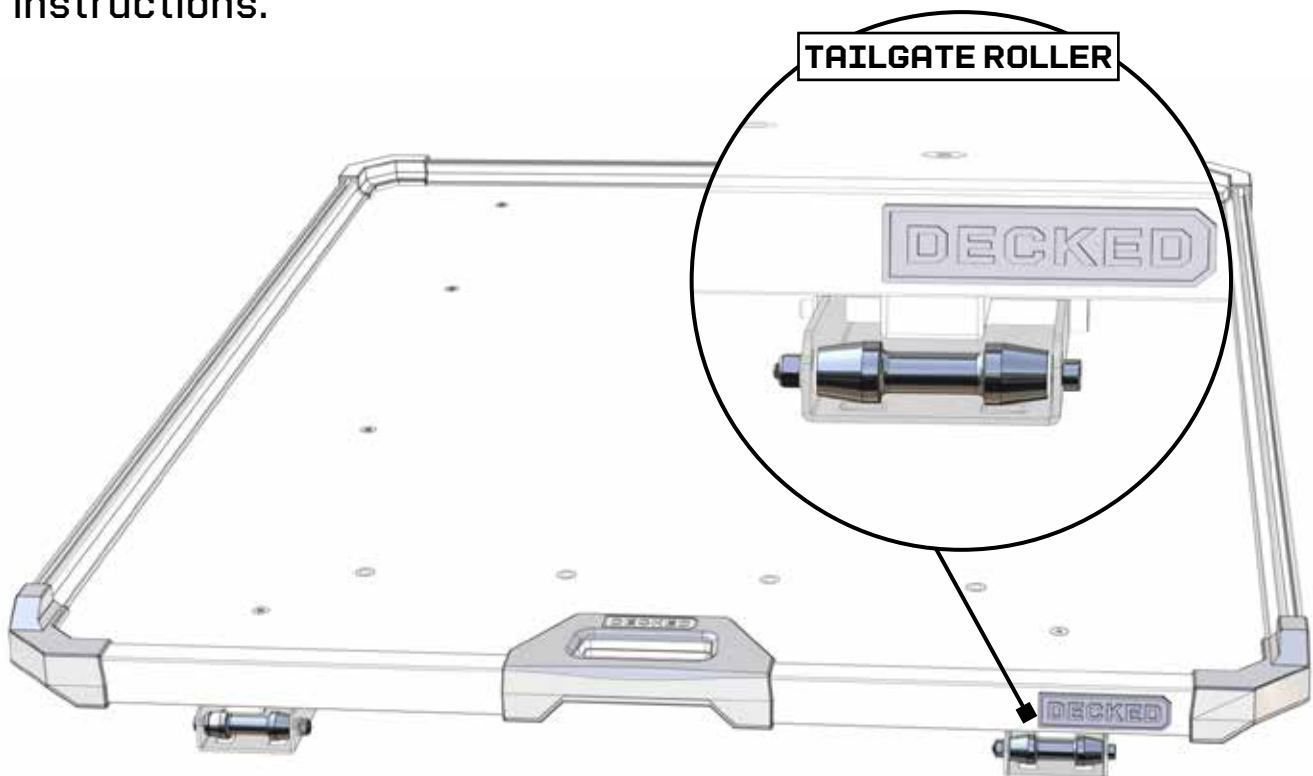

**INSTALL BOLT AND WASHER
INTO EACH PLUS NUT**

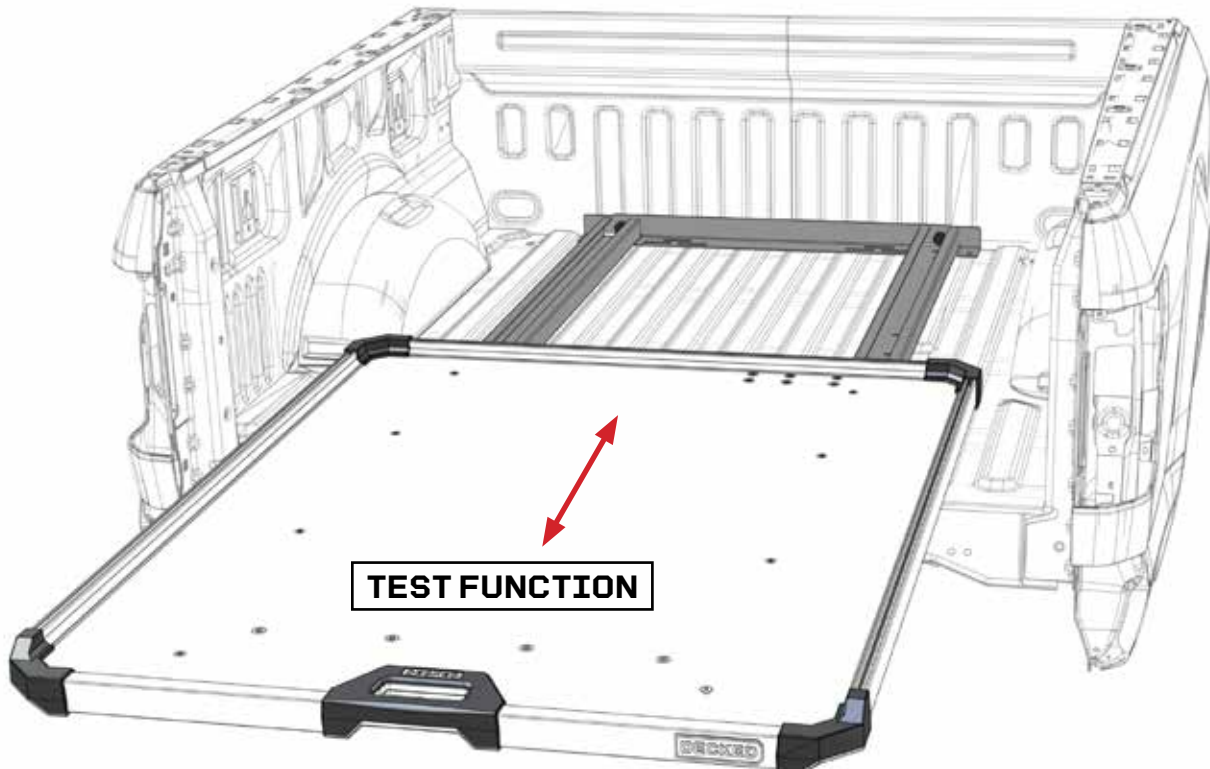
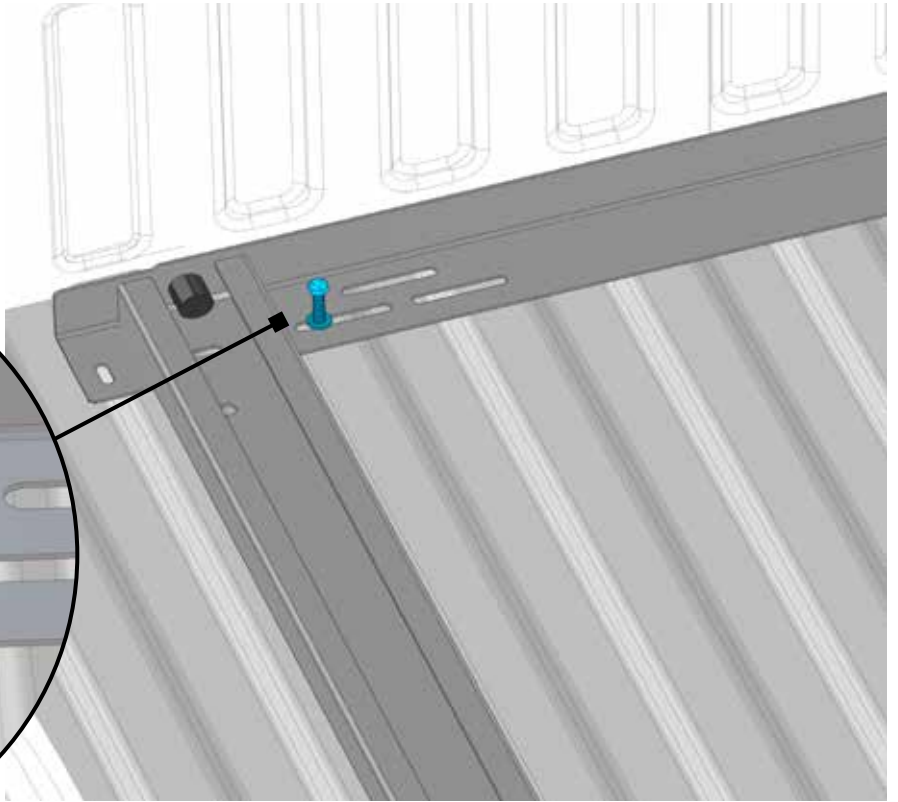
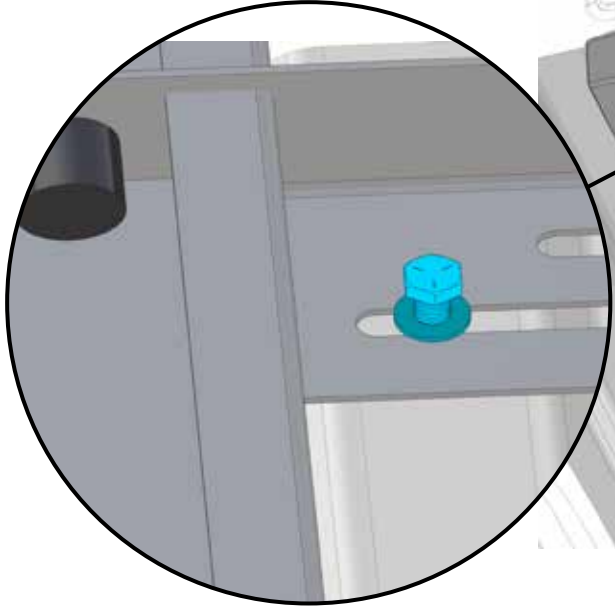

TROUBLESHOOTING

- **I CAN'T SQUEEZE MY HANDLE.**

When the CargoGlide unit is loaded, the handle latch release may be harder to squeeze - this is intended to keep the tray from moving while stowed.

Simply push the tray towards the cabside while squeezing the handle release to release the tray.

- **TIGHT TAILGATE ROLLERS**

If the tray is hard to extend or doesn't roll smoothly, the tailgate rollers may need to be adjusted.

Slide tray out until lift stop bracket clears base frame channel. Lift tray up and push a couple of inches towards the cabside to place the lift stop bracket on the bottom frame. **DETAIL A.**

Use 9/16" socket or wrench and 1/4" hex wrench to loosen the tailgate roller bolt one quarter (1/4) turn to loosen tailgate roller. **DETAIL B.**

Test function by spinning the roller with your hand. The roller should spin freely without excess side to side movement.

Loosen by 1/4 turn again if roller remains too tight. Confirm roller does not move side to side.

Replace tray and frame to original position and test function.

TROUBLESHOOTING

TIGHT TAILGATE ROLLERS - DETAIL A

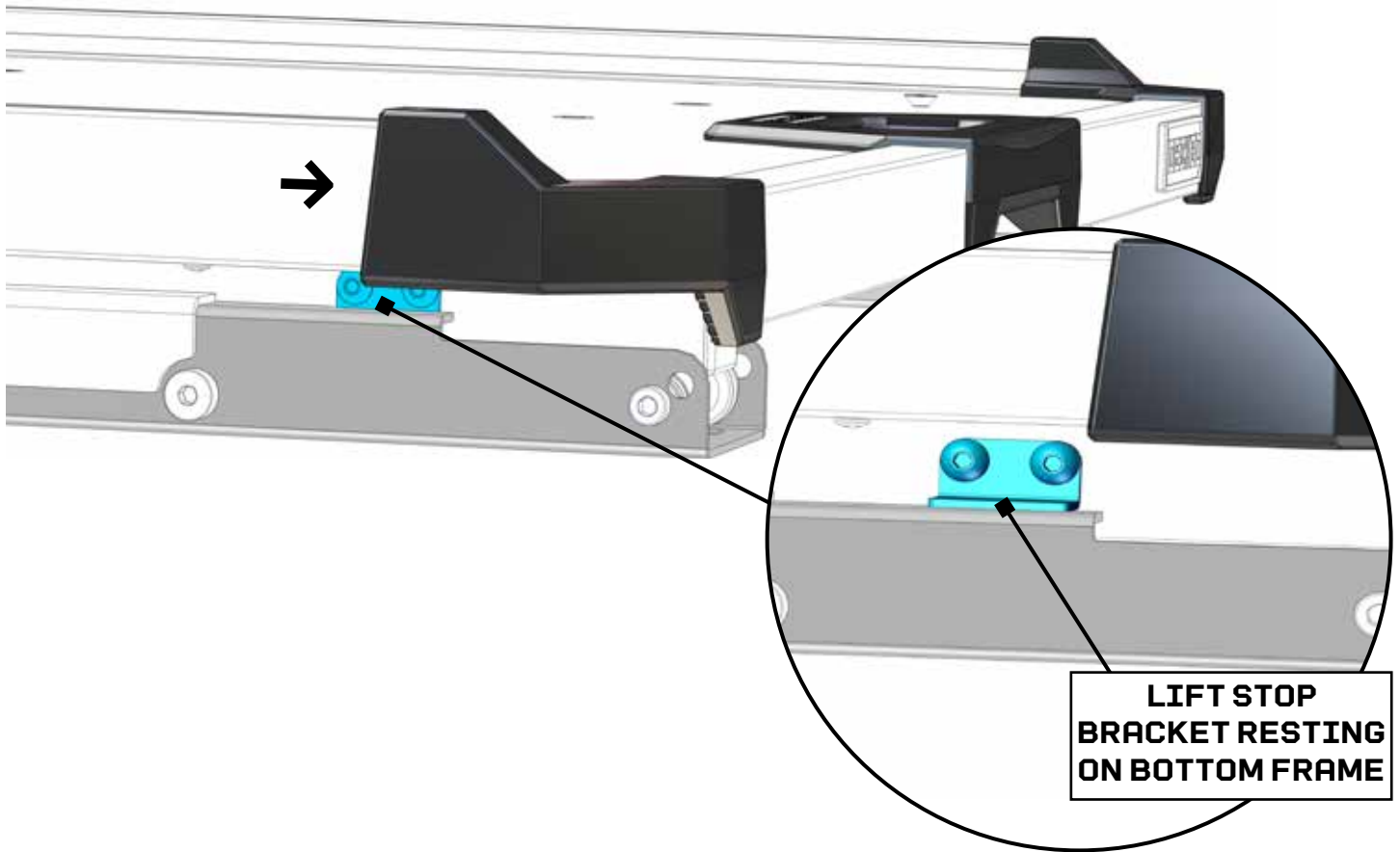

TIGHT TAILGATE ROLLERS - DETAIL B

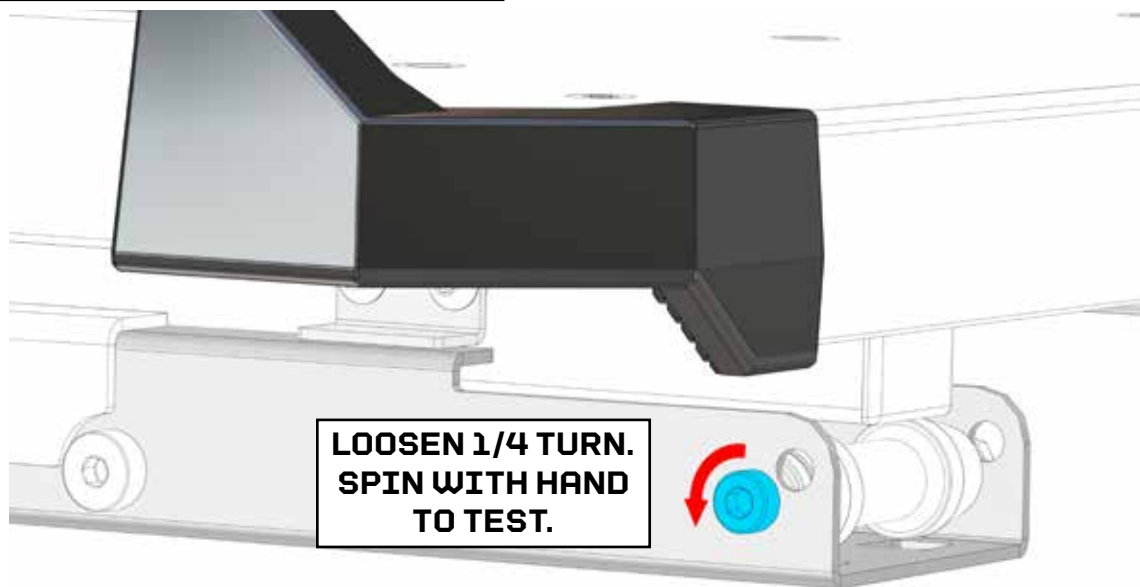

TROUBLESHOOTING

- **THE TRAY HITS MY TAILGATE.**

The position of the tray (73" and shorter units only) can be raised to clear angled tailgates. You'll need a 1/4" and 3/16" hex wrenches and a 9/16" wrench or socket. Follow these directions:

Slide tray out until lift stop bracket clears bottom frame channel.

Lift tray up and push a couple of inches towards the cabside to place the lift stop bracket on the bottom frame:

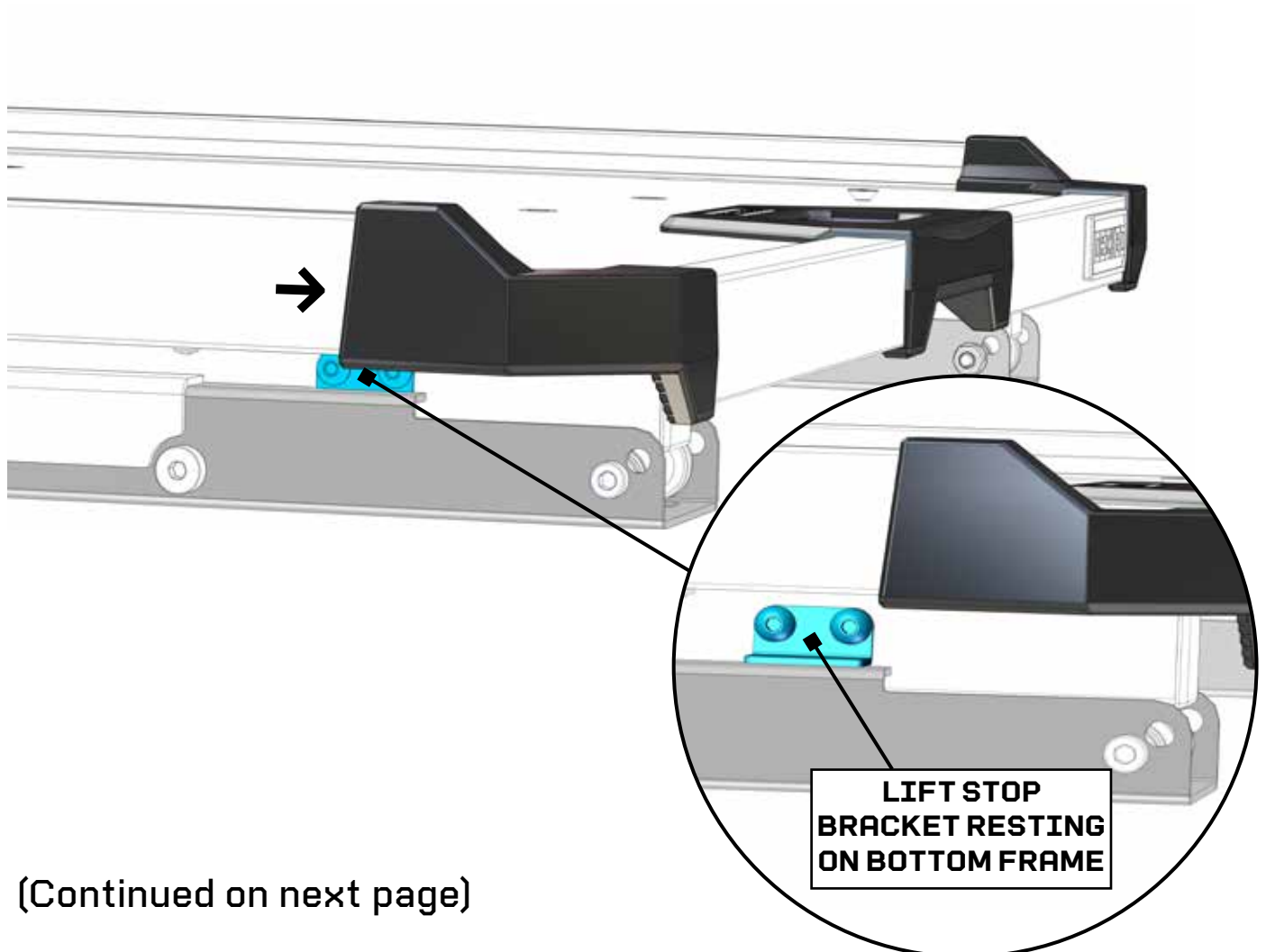

(Continued on next page)

TROUBLESHOOTING

RAISE TRAY

Remove the tailgate roller axles, nuts, thrust bearings, washer and rollers from both sides.

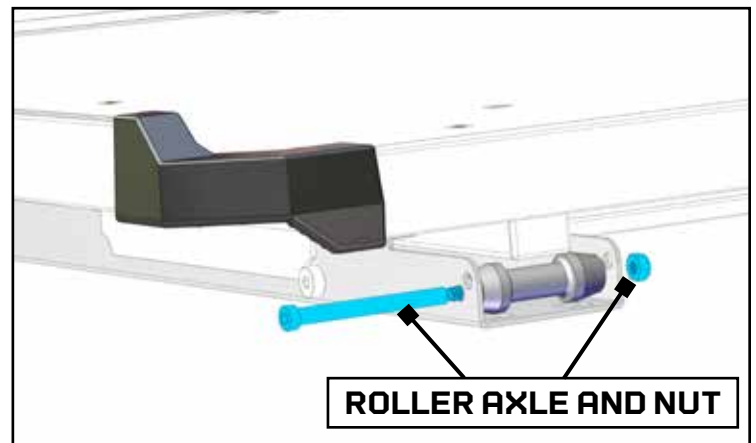

Using the upper mounting holes in the bottom frame, replace all parts in the same order on both sides.

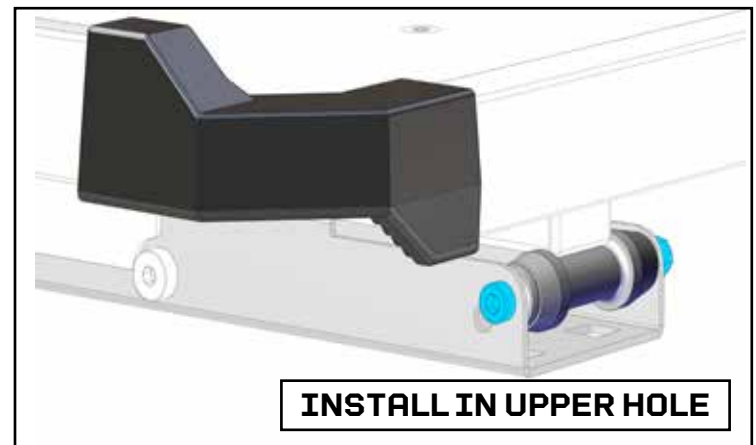

LEFT ROLLER ASSEMBLY

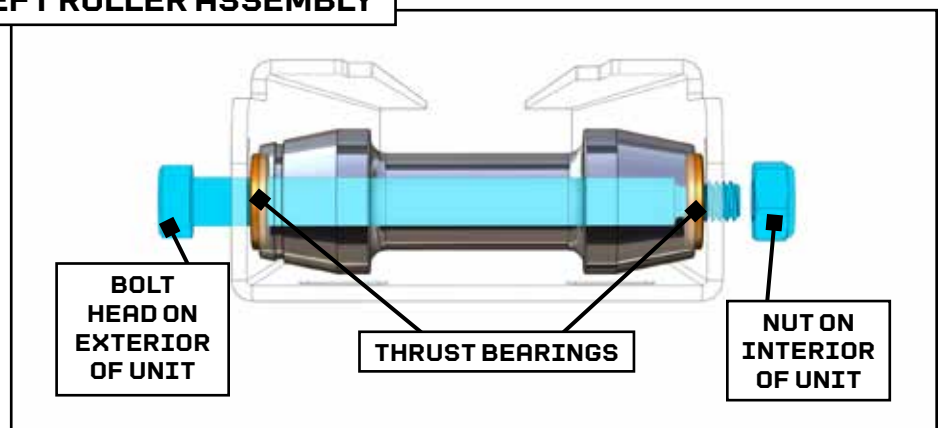

(Continued on next page)

TROUBLESHOOTING

RAISE TRAY, con't

Remove the lift stop brackets on either side with a 3/16" hex wrench.

Ask your buddy to lift the tray slightly so you can install the lift stop brackets on the interior of each upper tray tube.

IMPORTANT: These brackets **MUST** be replaced for safety purposes.

Lift and pull tray slightly towards the tailgate.

Seat brackets under lip on bottom mounting tube.

Stow tray in locked position.

Test function.

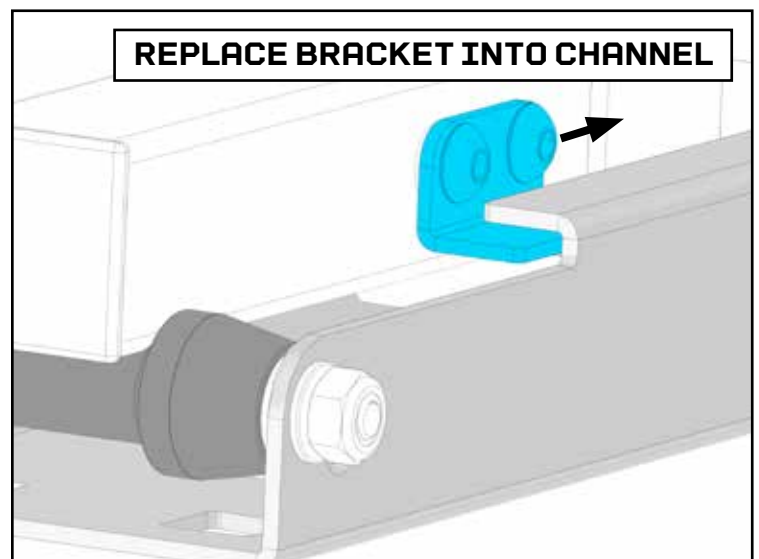
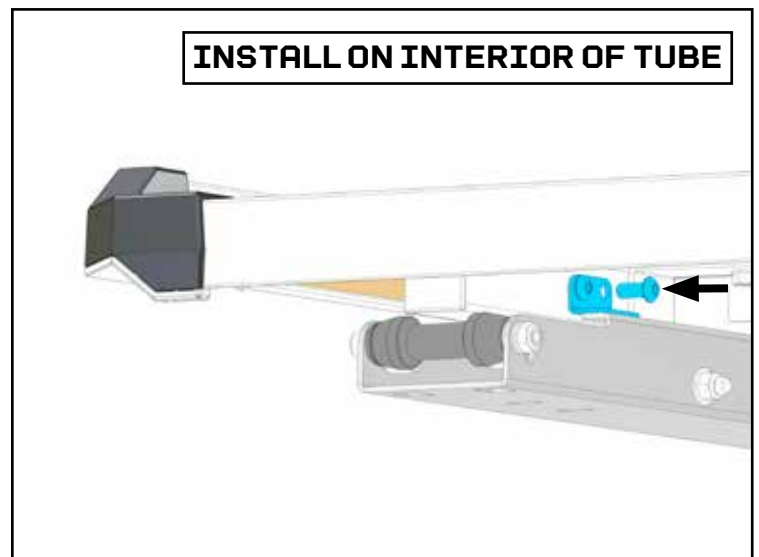
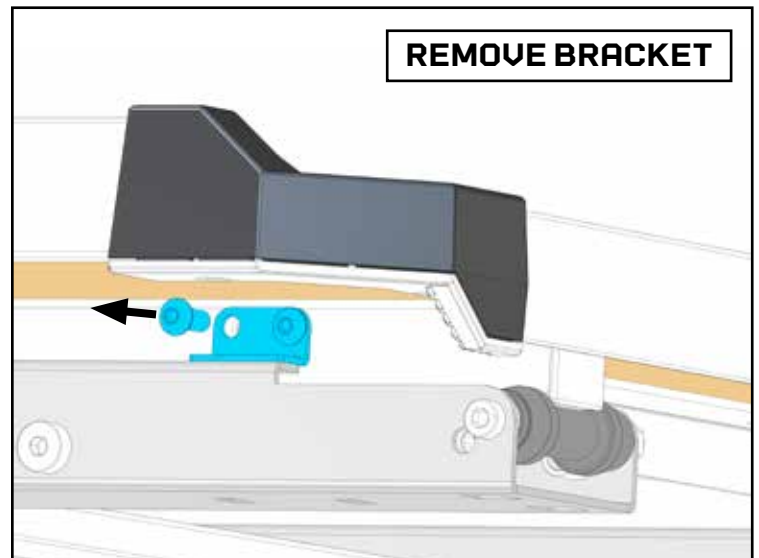

TROUBLESHOOTING

• I SQUEEZE MY HANDLE, BUT NOTHING HAPPENS.

Should the handle release stop functioning, the mechanism can be accessed by removing the upper tray from the tray tubes.

Remove the eight (8) screws shown with a 3/16" hex wrench. Save the screws for reinstallation.

Ask a friend to help you lift off the tray to expose the latch mechanism.

Need parts? Call us at 208-806-0251.

To reinstall the tray to the tray tubes, push the tubes all the way back to the cabside. Place the tray on top of the tray tubes.

There is a locating pin on the cabside of the tray tubes that will help you align the tray to the tray tubes. The latch may engage, and you might need to use the handle to disengage the latch as you fine tune positioning. Once the tray tube and tray are aligned, you should be able to see the threads in the tube. Start the tray bolts on the tailgate side, then the cab side, and hand tighten all bolts. Once all bolts are threaded, securely tighten all bolts. Tray bolts should be flush to the deck. Do not overtighten.

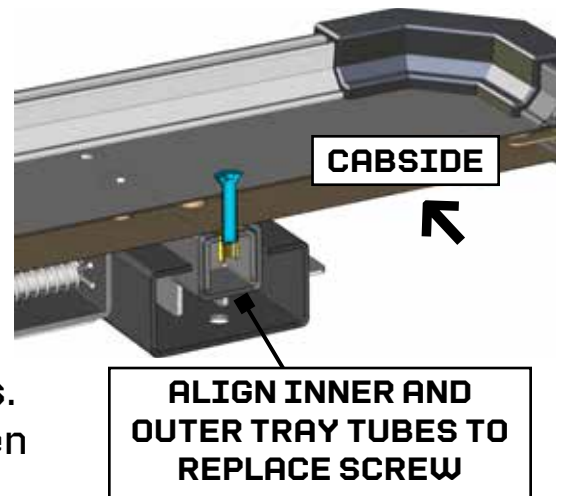
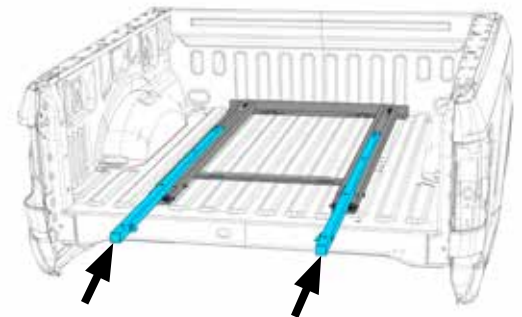
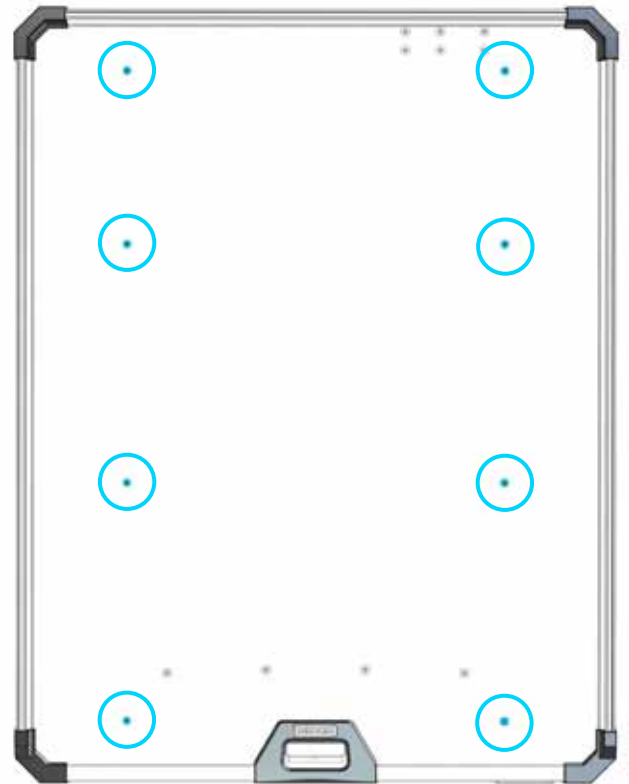

TROUBLESHOOTING

- **THE LATCH DOESN'T ENGAGE OR DISENGAGE FULLY.**

The latch cable may need to be adjusted after a period of use for optimum latch pin function.

The latch pin must fully engage the latch window in the side frame when the handle is released. **DETAIL A.**

The latch pin should just clear the base rail when the handle is squeezed; Do not allow the latch pin to recess inbound of the latch carrier. **DETAIL B.**

See next page for adjustment instructions.

UNDERSIDE OF
CARGOGLIDE
(cabside of bottom
frame is hidden)

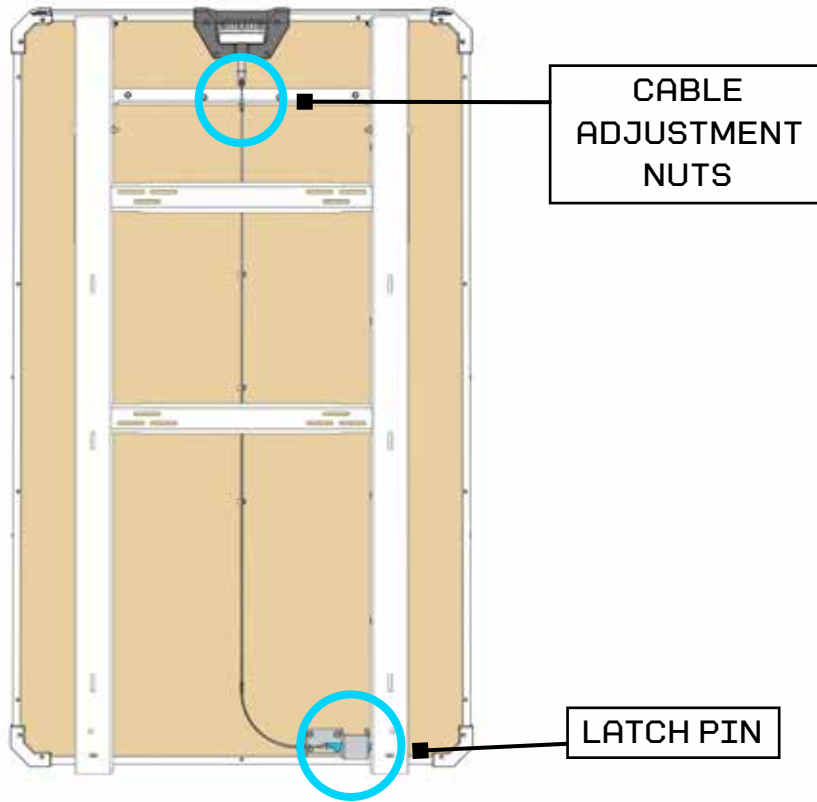

DETAIL A

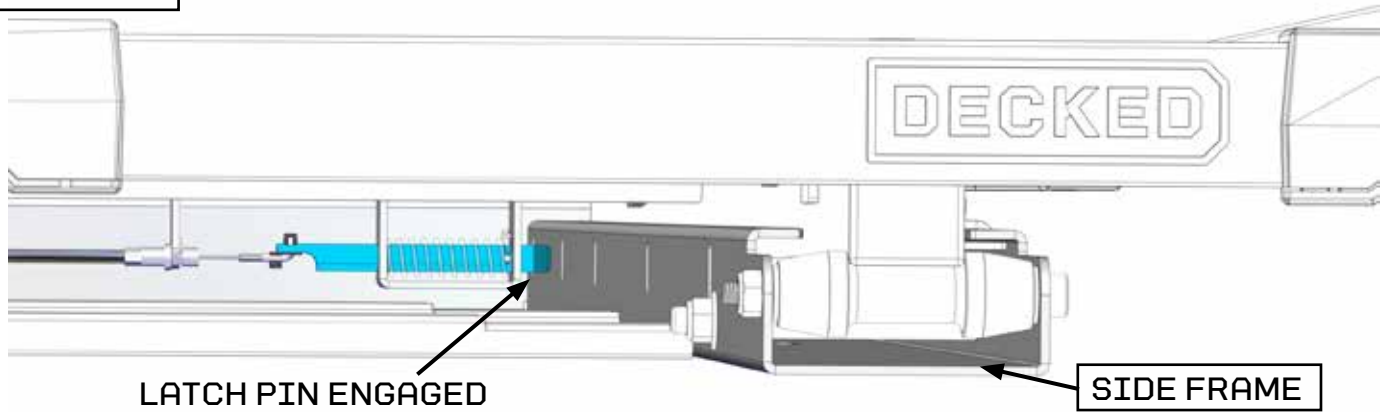

DETAIL B

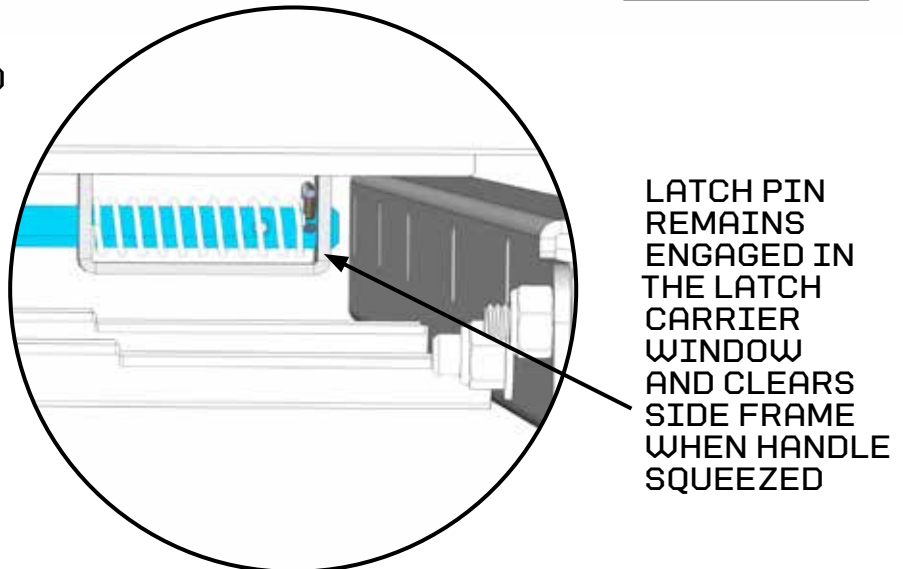

TROUBLESHOOTING

Deploy the tray far enough to access the area underneath the handle.

Locate the adjustment nuts. Loosen the nut closest to the handle.

The nut furthest from the handle controls the cable action:

Move this nut towards the tailgate for less latch pin engagement.

Move this nut towards the cabside for more pin engagement.

Once the pin disengages from and fully clears the base frame window, while also residing outside of the latch carrier, tighten both nuts around the tray stiffener.

Open and close the tray fully to confirm no rubbing.

Adjust further if necessary.

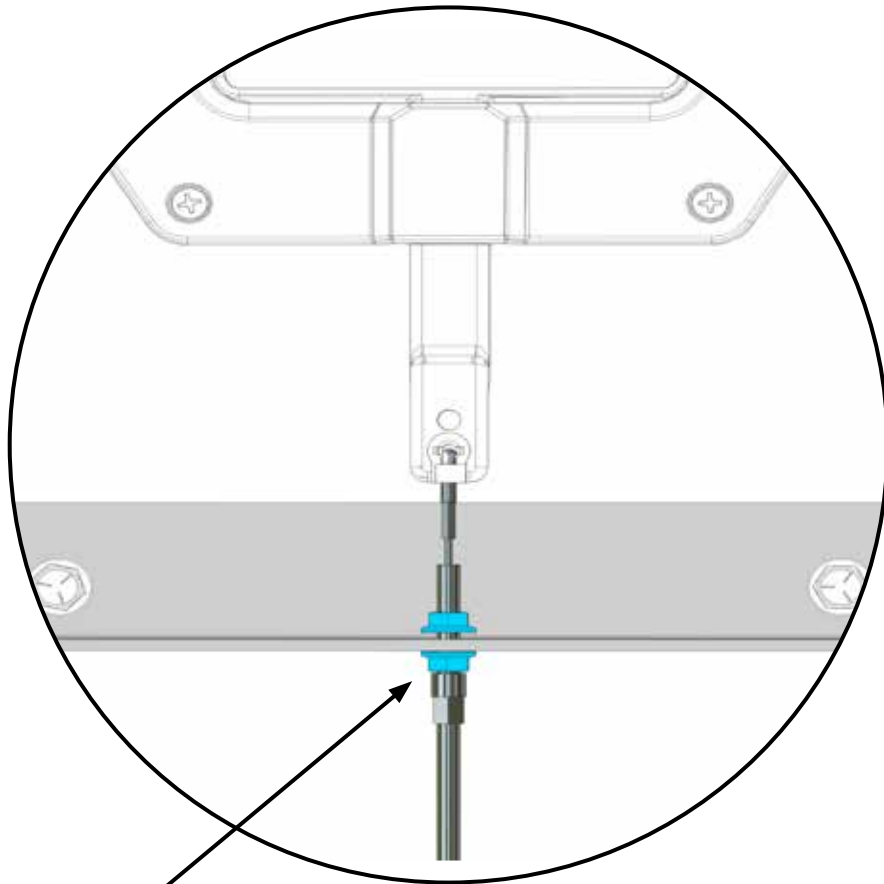

PULL TRAY OUT TO
ACCESS CABLE
ADJUSTMENT
NUTS

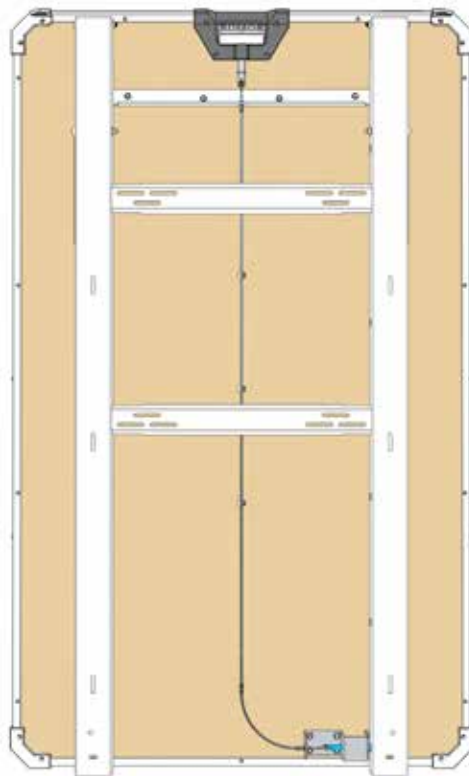

**CONGRATS,
GAME CHANGER!**

YOU DID IT.

Crack open a cold one of your liking, sit back and admire your work. Now get busy organizin'!



DECKED PRODUCTS

LIMITED LIFETIME WARRANTY

(Valid on DECKED Products purchased on or after 8/1/2021)

DECKED LLC, (the "Manufacturer") warrants the original purchaser only that DECKED Truck and Van Products (The "DECKED" Product) will be free from defects in material and workmanship from the date of purchase and continuing for the expected lifetime of the DECKED Product. The DECKED Product must be registered by the original purchaser with DECKED, LLC via its website at, decked.com/register, and a copy of the original sales receipt must be supplied to the Manufacturer at the time a warranty claim is made. This warranty terminates if the original purchaser transfers the DECKED Product to any other person or vehicle.

WHAT IS COVERED

All DECKED Products identified above on or after August 1, 2021. **DECKED's Limited Lifetime Warranty applies to US and Canadian customers only. International shipments are covered by DECKED's 3 Year Limited Warranty.**

WHAT WE WILL DO TO CORRECT PROBLEMS

Subject to the limitations and exclusions described in this limited warranty, the Manufacturer will remedy defects in workmanship or materials by providing one of the following remedies at its option and without charge to the original purchaser for parts: (a) repairing the defective portion of the DECKED Product or (b) replacing the entire DECKED Product. In addition, the Manufacturer may elect at its option not to repair or replace the DECKED Product, but rather issue to the original purchaser a refund equal to the purchase price paid for the DECKED Product or a credit to be used towards the purchase of a new DECKED Product.

WHAT IS NOT COVERED

This limited warranty expressly excludes:

- Damage or defects caused by normal wear and tear, cosmetic rust, scratches, accidents, unlawful vehicle operation, installation in a non-supported vehicle or installed in a vehicle which does not match the DECKED Product's SKU-intended fitment or use, or modification of the product, or any types of repair of a DECKED Product other than those authorized or provided by the Manufacturer.
- Damage or defects resulting from conditions beyond the Manufacturer's control and specifications including, but not limited to modification, misuse, overloading, or failure to assemble, install or use the DECKED Product in accordance with the Manufacturer's written instructions or guidelines included with the DECKED Product or separately made available to the original purchaser.
- Damage to the contents of the DECKED Product or vehicle.
- TO THE EXTENT PERMITTED BY LAW, IN NO EVENT SHALL THE MANUFACTURER BE LIABLE FOR ANY INCIDENTAL, SPECIAL, INDIRECT, OR CONSEQUENTIAL DAMAGES, INCLUDING ECONOMIC LOSS, WHETHER RESULTING FROM NONPERFORMANCE, USE, MISUSE, OR INABILITY TO USE THE DECKED PRODUCT OR THE MANUFACTURER'S NEGLIGENCE.

NO OTHER EXPRESS WARRANTY APPLIES

This Limited Lifetime Warranty is the sole and exclusive warranty for DECKED Products. No employee, agent, dealer, or other person is authorized to alter this warranty or make any other warranty on behalf of DECKED LLC.

NOTIFICATION PROCEDURES

If the DECKED Product does not conform with the terms of this limited warranty, the original purchaser must promptly notify the Manufacturer in writing upon discovery of the nonconformity. In order to receive remedies under this limited warranty, a warranty claim must have been registered with DECKED LLC by the original purchaser, must describe the nature of the products nonconformity, include a copy of the original sales receipt, invoice, or other proof of purchase and be accompanied with photos or video. Repairs or modifications made to the DECKED Product by other than the Manufacturer or its authorized agent will nullify this limited warranty. Coverage under this limited warranty is conditioned at all times upon the owner's compliance with these required registration, notification, and repair procedures.

Product registration may be performed at:
decked.com/register

Warranty claims must include reciprocal contact information and may be made via certified mail or email to:

DECKED Warranty and Claims
PO Box 885
Ketchum, ID 83340
warranty@decked.com
208-806-0251

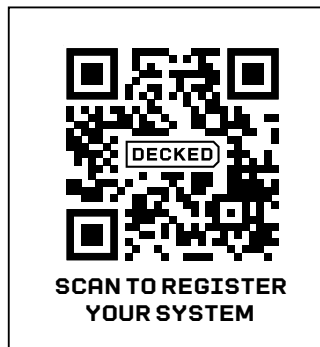

Register your system at
decked.com/warranty

PATENTS

MIDSIZE DRAWER SYSTEM:

US10988087B2, 112017005448.6, AU2017348386A1, 3042037

FULL SIZE DRAWER SYSTEM:

US9527454-B2, USD719905 S, US9168874 B2, CA2969118A1

TOOL BOX:

US20210062581A1

For more information on our patents visit: decked.com/patents

DECKED